

# ***REDON GTR*** TECHNICAL DATASHEET



# Holder Types



Standart Holder

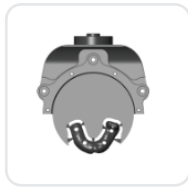

C Clamp



Semi Circle  
Disc Holder



Premill Holder



Glass Ceramic  
Holder



Glass Ceramic /  
Premill Holder



Denture Holder

# Applications



Abutments



Screw Retantion  
Bridge



Crown Bridge



Denture - Type 1



Denture - Type 2



Surgical Guide



Hybrid Abutment



Inlay, Onlay and  
Veners



Model Casting



Model



Splint

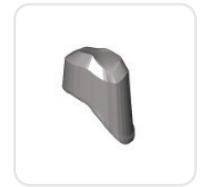

Telescope



Telescope Abutment

# Material Types

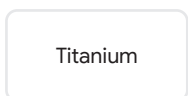

Titanium



CoCr

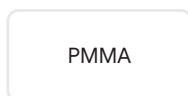

PMMA

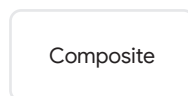

Composite

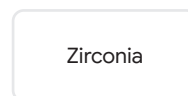

Zirconia

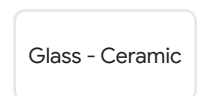

Glass - Ceramic

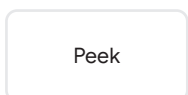

Peek

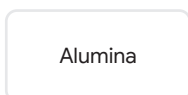

Alumina

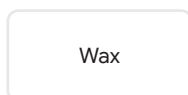

Wax

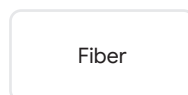

Fiber

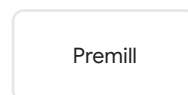

Premill

# Technical Specifications **GTR**

AXIS MOTOR TECHNOLOGY

**Dijital AC Servo**

SPINDLE SPEED

**60.000**RPM / STD

SPINDLE POWER

**3.7**kW / STD

NUMBER OF AXES

**5 Axes**

MAX. SLOPE ANGLE OF A AND B AXIS

**-30 / +120** Degrees (A Axis)  
**-30 / +210** Degrees (B Axis)

MAX TOOL SHAFT DIAMETER

**3 / 4 / 6 mm**

ATC CAPACITY

**12**

DRY AND WET MILLING

**Yes**

REFERENCING MILLING REQUIREMENT

**No**

VOLTAGE / FREQUENCY

**110v - 230v / 50-60Hz**

PRESSURIZED AIR REQUIREMENT (L/Min.)

**100 L / Min.**

AIR PRESSURE (BAR)

**6**

CAM SOFTWARE

**Open System**

DEVICE DIMENSIONS

**630 x 660 x 760 mm**

STANDARTS

Glass Ceramic / Premill Holder, Semi-Circle Disc Holder, Disc Holder, Zircon Bur Set, Allen Set, Spindle Cleaning Kit, Air Hose, Air Gun  
Water Hose, Water Tank, Cutting Oil, Cleaning Brush, Pump, Adapter, Ethernet Cable, Fuses, Usb

OPTIONS

Table, Vacuum Unit, Sinter Furnace, Scanner